

PRINCIPAL CONTRACTOR

ULTIMATE MOTORSPORT EVENTS



1300 768 657  
www.workzone.net.au

LOCATION: Clarendon Stage

COUNCIL: City of Onkaparinga /Adelaide Hills Council

DRAWING NUMBER: WZTC - TGS - 7250

ROAD CATEGORY: 1

DRAWING EXPIRY: 23/09/2026

SHEET NUMBER: 1

WORK DESCRIPTION: Adelaide Hills Rally 2025

NOTES: Road closures - EVENT



NOT TO SCALE



SOUTH AUSTRALIAN  
OWNED & OPERATED

SAPOL - 131 444 • TRAFFIC MANAGEMENT CENTRE - 1800 018 313

DISCLAIMER:  
This Traffic Guidance Scheme (TGS) has been drafted on behalf of Workzone Traffic Control (WZTC). Changes to the layout of this TGS shall be reported to WZTC and recorded prior to implementation. Changes required outside of general tolerances by the Traffic Controller shall constitute a hold point and shall be approved by a Traffic Management Planner prior to implementation. Traffic control devices shall be placed in accordance with the SA Standard for Workzone Traffic Management & the Australian Standards AS 1742.3 2019. WZTC is not liable for the incorrect use of this TGS. This TGS has been prepared based on information obtained via a desktop investigation, risk assessment, and information provided by the Principal Contractor. Where conditions vary from those identified in the development of this TGS, additional input from a Traffic Management Planner should be sought and any changes documented.

REV#	DETAILS	DRAWN BY	DATE	REVIEWER
1.0	Issued for implementation	Ryan Williams	11/07/2024	Victoria Altintas-Sheldon
1.2	TGS revised for reissue	Ryan Williams	23/09/2025	Scott Blackburn

Legend

START

Start of Race

FINISH

End of Race

Rally Route

Marshal

FOR CONTINUATION REFER TO  
ADDITIONAL MAP ON SHEET 2

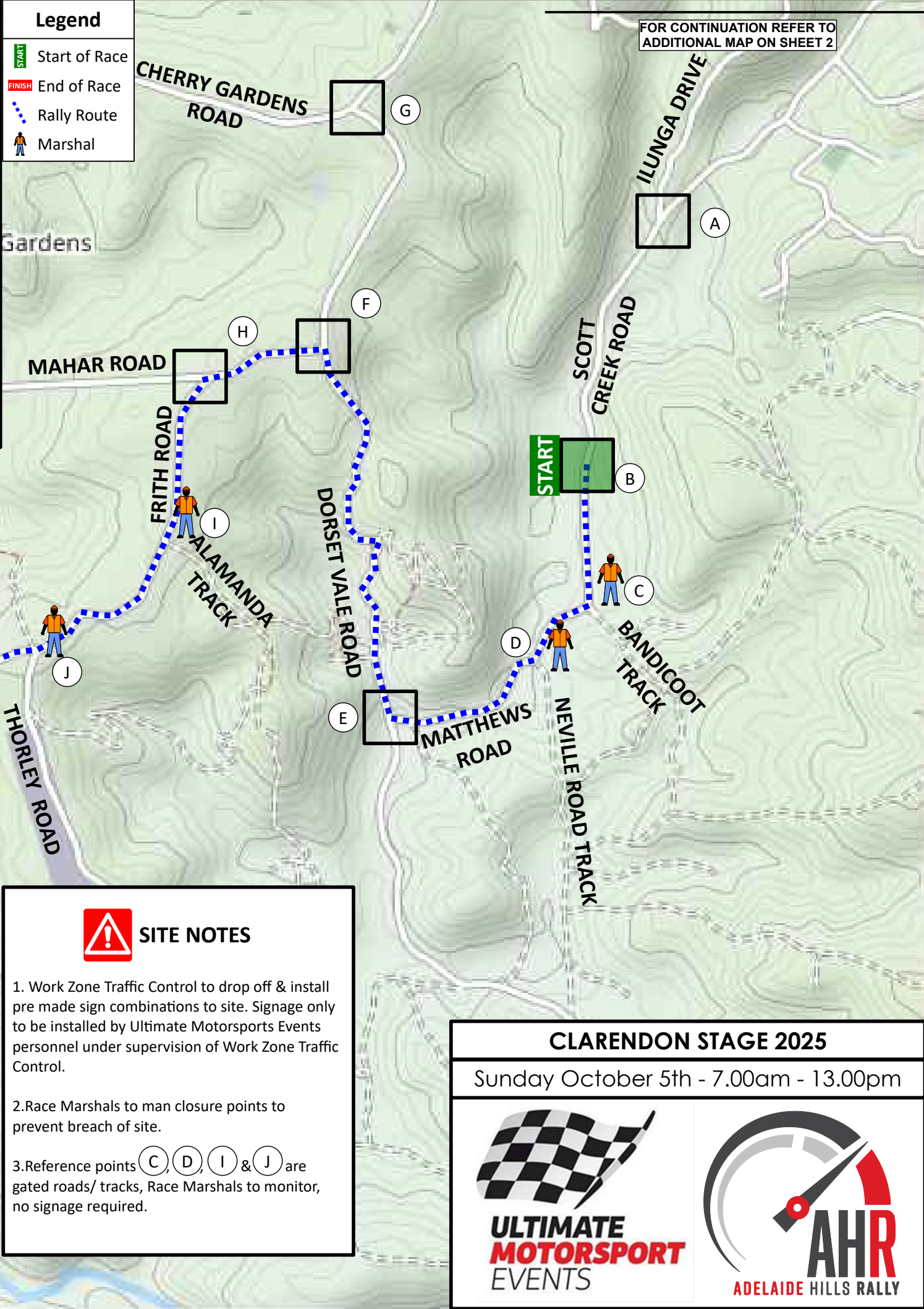

The map shows a rally route starting at point B on Scott Creek Road, passing through points C, D, E, F, G, H, I, J, and K. The route includes roads such as Cherry Gardens Road, Ilunga Drive, Scott Creek Road, Mahar Road, Frith Road, Dorset Vale Road, Matthews Road, Neville Road Track, Bandicoot Track, Frith Road, Alamanda Track, Thorley Road, Formby Road, and Potter Road. A 'START' box is located at point B, and a 'FINISH' box is located at point K. A 'NOT TO SCALE' warning is present. A 'SOUTH AUSTRALIAN OWNED & OPERATED' logo is also visible.

SITE NOTES

For road closure set ups, refer to Sheet 2.

SITE NOTES

1. Work Zone Traffic Control to drop off & install pre made sign combinations to site. Signage only to be installed by Ultimate Motorsports Events personnel under supervision of Work Zone Traffic Control.

2. Race Marshals to man closure points to prevent breach of site.

3. Reference points C, D, I & J are gated roads/ tracks, Race Marshals to monitor, no signage required.

CLARENDON STAGE 2025

Sunday October 5th - 7.00am - 13.00pm



ULTIMATE  
MOTORSPORT  
EVENTS



AHR  
ADELAIDE HILLS RALLY

NO HEAVY VEHICLE ROUTES OR DIT ROADS



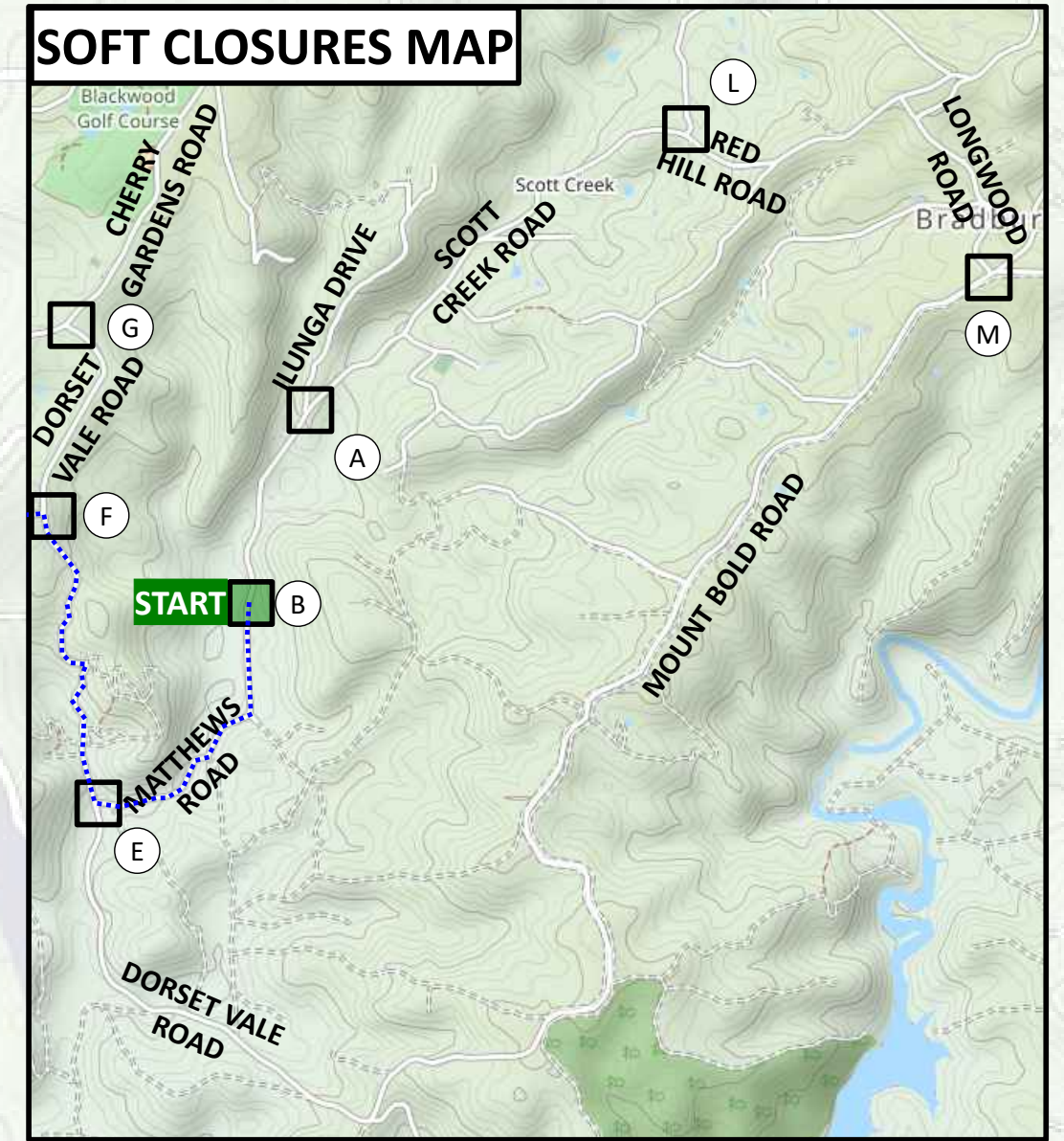
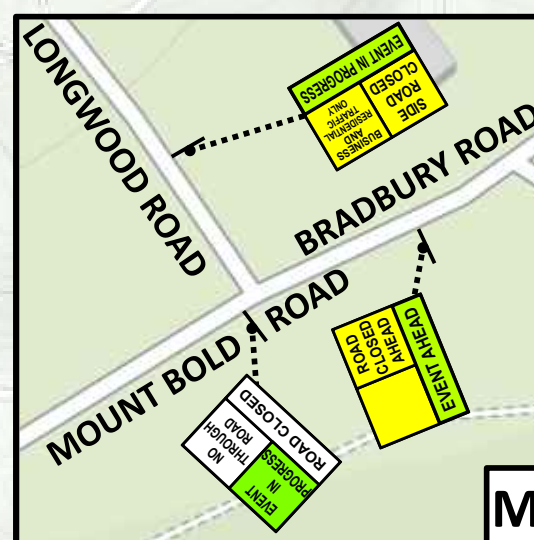
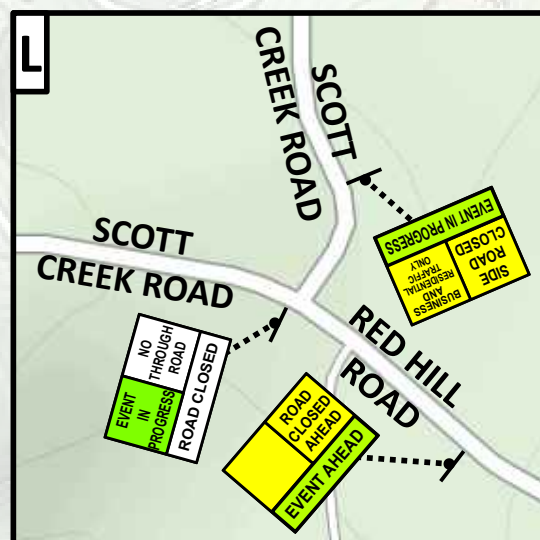
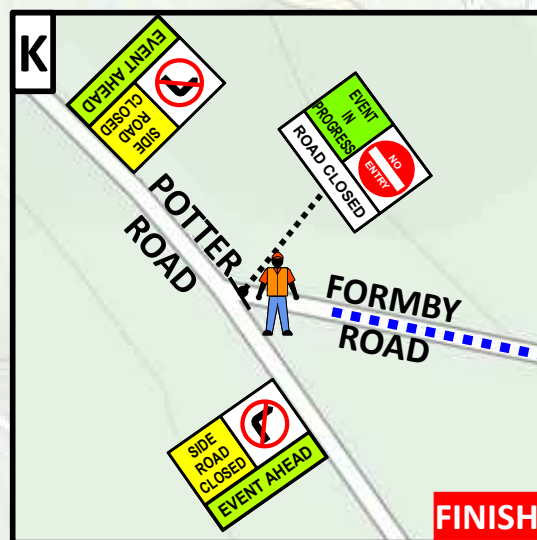
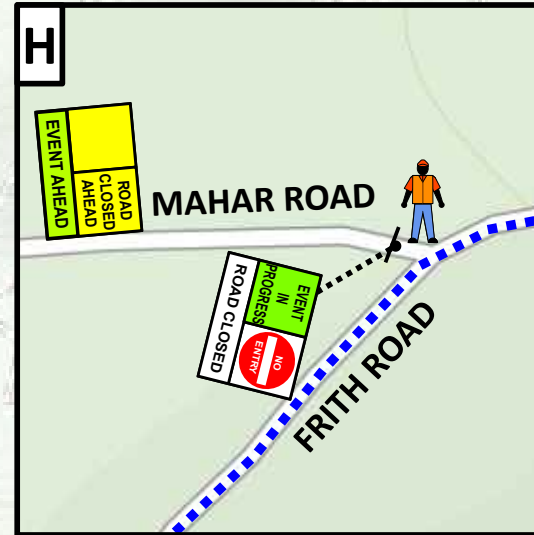
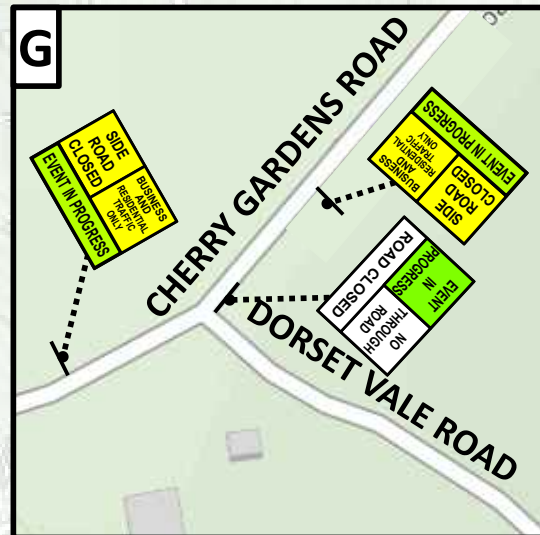
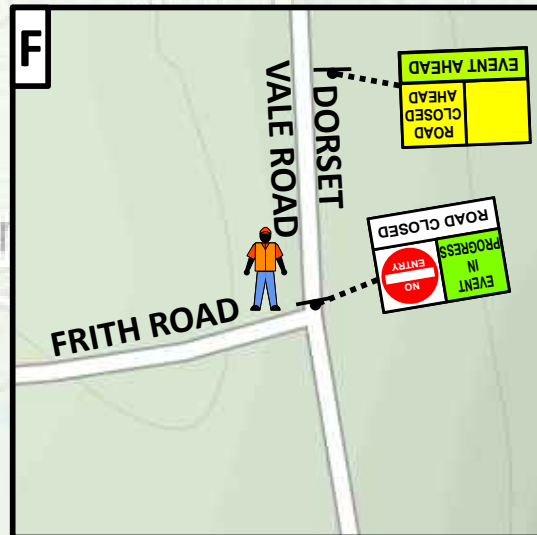
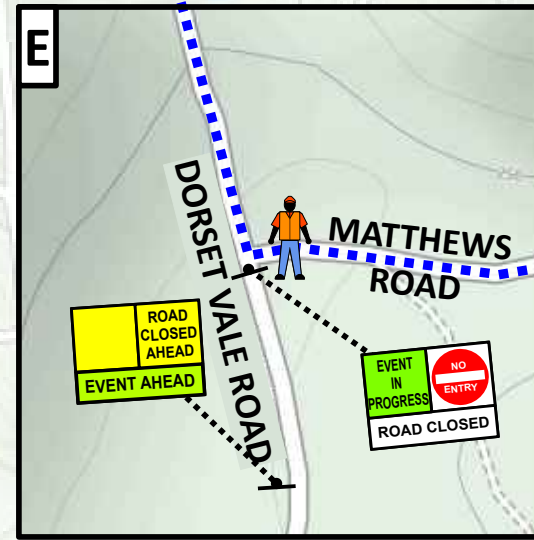
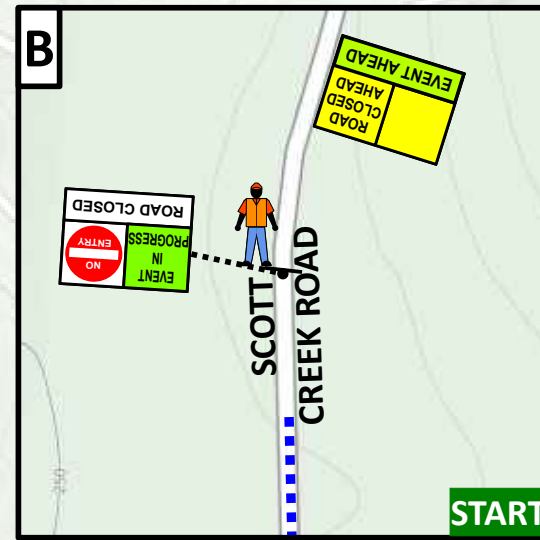
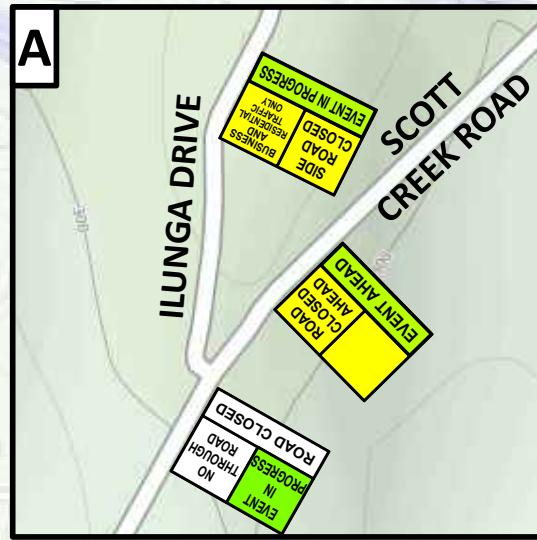

**CLARENDON STAGE 2025**

